

Jamicon Series : LB

Teapo Series : GA

Long Life&Large Capacitance



■ Endurance: 85°C 3000hours

■ Recommended Applications : Applying to switching power supply and other industry/ commercial field

■ Corresponding product to RoHS

■ SPECIFICATIONS

Item	Characteristics												
Category Temperature Range	-40~+85°C	-25~+85°C											
Rated Voltage Range	16 ~ 500VDC	> 500 VDC											
Rated Capacitance Range	560 ~ 270000 μF	330 ~ 1200 μF											
Capacitance Tolerance	± 20 % ( 120Hz , 20°C)												
Leakage Current (20°C)	DC≤500V I = 3 √V DC> 500V I=0.02CV or 3mA whichever is greater (After rated voltage applied for 5 minutes) I : Max. leakage current ( μ A), C : Nominal capacitance ( μ F), V : Rated voltage (V)												
Dissipation Factor(MAX) (tan δ) (120Hz , 20°C)	WV	16	25	35	50	63	80	100	160~450	500~550			
	Capacitance	—	—	—	—	≤27,000	>27,000	≤15,000	>15,000	—	—		
	tan δ	35 Φ	0.80	0.60	0.50	0.40	0.35	0.40	0.25	0.30	0.25	0.15	0.20
		40 Φ	0.90	0.70	0.60	0.45	0.35	0.40	0.25	0.30	0.25	0.15	0.20
45 Φ	1.00	0.80	0.70	0.50	0.35	0.40	0.25	0.30	0.25	0.15	0.20		
50 Φ	1.20	1.00	0.75	0.55	0.35	0.40	0.25	0.30	0.25	0.15	0.20		
Low Temperature Stability Impedance Ratio (MAX)	Measurement frequency : 120Hz												
	WV	16~100		160~250		350~450		500~550					
	Z-25°C / Z+20°C	4		6		8		8					
Z-40°C / Z+20°C	15		—		—		—						
Endurance	After applying rated voltage with rated Ripple current for 3000hrs at 85°C ,when the capacitors are restored to 20°C , the capacitor shall meet the following requirements.												
	Capacitance change					Within ± 20% of initial value							
	D.F. (tan δ)					Not more than 200% of specified value							
Shelf Life	The following specifications shall be satisfied when the capacitors are restored to 20°C after exposing them for 1,000 hours at 85°C without voltage applied. Before the measurement, the capacitor shall be preconditioned by applying voltage according to item 4.1 of JIS C 5101-4.												
	Leakage current					initial specified value or less							

■ Dimensions [mm]

Code 11~13 : S1G(35 Φ)

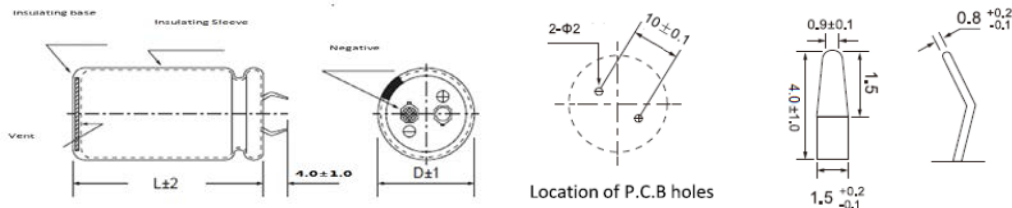

Code 11~13 : L4A(35~45 Φ)

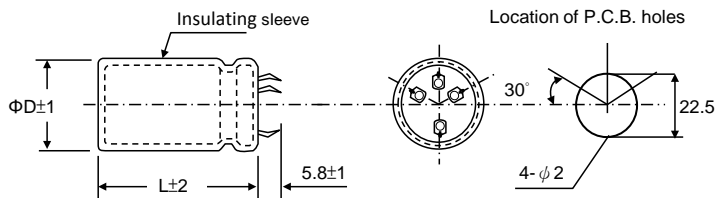

Code 11~13 : L5A(50 Φ)

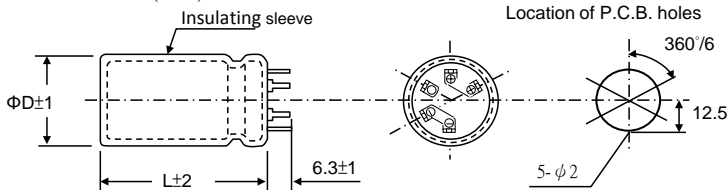

※When the code 11~13 of part number is S1G, the terminal length of standard capacitor is 4.0±1.0mm, and when it is S1A, the terminal length of standard capacitor is 5.8±1.0mm.

■ Multiplier for Ripple Current

Freq. (Hz)	60	120	400	1K	10K
≤100V	0.80	1.00	1.10	1.20	1.20
>100V	0.80	1.00	1.10	1.30	1.40

Jamicon Series : LB

Teapo Series : GA

■ STANDARD RATINGS

Rated Voltage (SurageVoltage) (V)	Cap ( $\mu$ F)	Case size $\Phi$ DxL(mm)	$\tan \delta$	Ripple current (A/rms85°C) (120Hz)	Rated Voltage (SurageVoltage) (V)	Cap ( $\mu$ F)	Case size $\Phi$ DxL(mm)	$\tan \delta$	Ripple current (A/rms85°C) (120Hz)
16 (20)	82000	35x60	0.80	10.25	50 (63)	33000	35x80	0.40	9.41
		45x51	1.00	10.38			40x61	0.45	9.11
	100000	35x80	0.80	11.15			45x60	0.50	9.18
		40x61	0.90	11.60			50x50	0.55	10.73
		45x50	1.00	10.84			35x90	0.40	9.99
	120000	35x80	0.80	12.39		40x81	0.45	10.44	
		40x81	0.90	12.47		45x70	0.50	9.92	
		45x60	1.00	11.10		50x60	0.55	11.52	
		50x50	1.20	13.47		35x100	0.40	10.59	
	150000	40x91	0.90	13.55		40x91	0.45	11.18	
		45x70	1.00	12.23		45x70	0.50	10.09	
		50x60	1.20	14.83		50x60	0.55	11.88	
	180000	40x101	0.90	14.92		40x101	0.45	11.77	
		45x80	1.00	13.61		45x90	0.50	11.31	
		50x80	1.20	16.05		50x80	0.55	12.75	
220000	45x90	1.00	15.16	45x100	0.50	12.5			
	50x90	1.20	17.35	50x90	0.55	13.70			
	270000	50x100	1.20	17.81	82000	50x100	0.55	12.50	
25 (32)	56000	35x60	0.60	8.81	63 (79)	15000	35x60	0.35	7.74
		40x51	0.70	9.12			40x51	0.35	8.46
	68000	35x80	0.60	10.62			18000	35x80	0.35
		40x61	0.70	10.48		40x61	0.35	9.47	
		45x50	0.80	9.66		45x50	0.35	9.33	
	82000	35x90	0.60	11.35		22000	35x90	0.35	10.27
		40x71	0.70	11.02		40x71	0.35	9.94	
		45x60	0.80	10.26		45x60	0.35	9.89	
	100000	50x50	1.00	12.54		27000	35x100	0.35	10.44
		35x100	0.60	12.06		40x81	0.35	10.94	
		40x81	0.70	12.41		45x70	0.35	10.97	
		45x70	0.80	11.63		50x50	0.35	11.15	
		50x60	1.00	13.68		40x101	0.40	12.08	
	120000	40x91	0.70	13.75		33000	45x80	0.40	11.62
		45x80	0.80	12.96		50x60	0.40	11.67	
		50x80	1.00	15.38		45x90	0.40	11.93	
	150000	40x101	0.70	14.00		39000	50x70	0.40	12.22
		45x90	0.80	13.36		47000	45x100	0.40	12.67
		50x90	1.00	16.29		50x80	0.40	13.19	
	180000	45x100	0.80	14.61		56000	50x100	0.40	14.05
		50x100	1.00	17.31		80 (100)	10000	35x60	0.25
33000		35x60	0.50	7.97	12000		35x70	0.25	8.26
39000	35x60	0.50	8.00	40x51	0.25		7.77		
	40x51	0.60	8.22	45x50	0.25		8.26		
47000	35x80	0.50	9.56	15000	35x80		0.25	8.91	
	40x61	0.60	9.74	40x61	0.25		8.52		
	45x50	0.70	8.88	45x60	0.25		9.06		
56000	35x90	0.50	10.53	18000	35x90		0.30	10.34	
	40x81	0.60	10.83	40x81	0.30		10.61		
	45x60	0.70	9.76	45x70	0.30		10.64		
	50x50	0.75	10.97	50x50	0.30		10.13		
68000	35x100	0.50	11.07	22000	35x100		0.30	10.18	
	40x91	0.60	11.64	40x91	0.30		10.49		
	45x70	0.70	11.08	45x80	0.30		10.58		
	50x60	0.75	12.23	50x60	0.30		11.36		
82000	40x101	0.60	12.33	27000	40x101		0.30	11.75	
	45x90	0.70	12.07	45x90	0.30		11.90		
	50x80	0.75	13.22	50x80	0.30		12.43		
100000	45x100	0.70	12.81	33000	45x100		0.30	12.26	
	50x90	0.75	14.22	50x90	0.30		13.44		
	120000	50x100	0.75	15.02	39000		50x100	0.30	14.71
50 (63)	27000	35x80	0.40	9.14	100 (125)	6800	35x60	0.25	7.22
		40x51	0.45	8.16		8200	40x51	0.25	7.45
		45x50	0.50	8.23		8200	35x70	0.25	8.07

Jamicon Series : LB

Teapo Series : GA

■ STANDARD RATINGS

Rated Voltage (SurageVoltage) (V)	Cap ( $\mu$ F)	Case size $\Phi$ D $\times$ L(mm)	tan $\delta$	Ripple current (A/rms85°C) (120Hz)	Rated Voltage (SurageVoltage) (V)	Cap ( $\mu$ F)	Case size $\Phi$ D $\times$ L(mm)	tan $\delta$	Ripple current (A/rms85°C) (120Hz)
100 (125)	8200	45x61	0.25	8.40	200 (250)	2700	40x61	0.15	5.91
		50x50	0.25	8.28			45x50	0.15	8.83
	10000	35x90	0.25	9.21		3300	35x80	0.15	6.48
		40x71	0.25	8.67			40x61	0.15	6.19
		45x60	0.25	8.63			45x60	0.15	6.58
	12000	50x50	0.25	9.00		3900	50x50	0.15	7.58
		35x100	0.25	8.83			35x90	0.15	7.22
		40x81	0.25	8.92			40x71	0.15	6.99
		45x70	0.25	8.94			45x60	0.15	6.96
	15000	50x60	0.25	10.34		4700	50x60	0.15	8.87
		40x101	0.25	10.30			40x91	0.15	7.84
		45x80	0.25	9.91			45x70	0.15	7.45
	18000	50x70	0.25	10.96		5600	50x70	0.15	9.90
		45x90	0.25	10.25			40x101	0.15	8.13
50x80		0.25	11.12	45x80	0.15		7.82		
22000	50x100	0.25	12.59	50x70	0.15	10.26			
160 (200)	3300	35x60	0.15	6.33	6800	45x90	0.15	8.13	
		40x51	0.15	6.38		50x80	0.15	11.66	
	3900	35x80	0.15	7.43	7500	45x100	0.15	8.26	
		40x61	0.15	7.48		50x90	0.15	12.54	
		45x50	0.15	7.37		50x100	0.15	13.36	
	47000	35x90	0.15	8.38	8200	35x60	0.15	4.56	
		40x81	0.15	8.37		40x51	0.15	4.59	
		45x60	0.15	7.85		35x80	0.15	5.29	
		50x50	0.15	8.40		40x61	0.15	5.06	
	5600	35x100	0.15	8.30	2200	45x50	0.15	4.98	
		40x81	0.15	8.37		35x80	0.15	5.86	
		45x60	0.15	7.86		40x81	0.15	6.34	
		50x60	0.15	9.12		45x60	0.15	5.95	
	6800	40x101	0.15	8.34	2700	50x50	0.15	6.86	
		45x80	0.15	8.02		35x100	0.15	7.17	
		50x70	0.15	9.82		40x81	0.15	7.01	
	8200	45x90	0.15	8.24	3300	45x70	0.15	7.03	
		50x80	0.15	10.04		50x60	0.15	7.97	
	10000	45x100	0.15	8.75		3900	40x101	0.15	8.19
		50x90	0.15	10.46	45x80		0.15	7.87	
12000	50x100	0.15	12.00	50x70	0.15		8.57		
180 (225)	2200	35x60	0.15	5.69	4700	45x90	0.15	8.84	
		35x70	0.15	5.06		50x80	0.15	9.69	
	2700	40x61	0.15	5.14	5600	45x100	0.15	9.82	
		35x80	0.15	5.58		50x90	0.15	10.84	
		40x61	0.15	5.68		50x100	0.15	12.16	
	3300	45x50	0.15	5.59	6800	35x60	0.15	3.84	
		35x90	0.15	5.78		40x51	0.15	3.86	
		40x71	0.15	6.56		35x80	0.15	4.67	
		45x60	0.15	6.16		40x61	0.15	4.46	
	3900	50x50	0.15	7.06	1200	45x50	0.15	4.39	
		35x100	0.15	6.18		50x50	0.15	5.22	
		40x81	0.15	6.74		35x80	0.15	5.09	
	4700	45x70	0.15	6.33	1500	40x71	0.15	5.2	
		50x60	0.15	7.89		45x60	0.15	5.18	
		40x101	0.15	7.85		50x60	0.15	6.03	
	5600	45x80	0.15	7.55	1800	35x100	0.15	6.03	
		50x70	0.15	8.37		40x81	0.15	5.90	
	6800	45x90	0.15	8.45		45x80	0.15	6.26	
50x80		0.15	8.51	50x80	0.15	3.97			
8200	45x100	0.15	8.64	2200	40x101	0.15	7.03		
	50x90	0.15	8.74		45x90	0.15	7.12		
10000	50x100	0.15	9.27		50x90	0.15	7.93		
200 (250)	2200	35x60	0.15	5.69	2700	45x100	0.15	8.06	
		40x51	0.15	5.47		50x100	0.15	8.98	
	2700	35x70	0.15	5.83	400 (450)	820	35x60	0.15	3.55

Jamicon Series : LB

Teapo Series : GA

■ STANDARD RATINGS

Rated Voltage (SurageVoltage) (V)	Cap ( $\mu$ F)	Case size $\Phi$ D $\times$ L(mm)	tan $\delta$	Ripple current (A/rms85°C) (120Hz)	Rated Voltage (SurageVoltage) (V)	Cap ( $\mu$ F)	Case size $\Phi$ D $\times$ L(mm)	tan $\delta$	Ripple current (A/rms85°C) (120Hz)	
400 (450)	820	40x51	0.15	3.58	500(550)	470	45x50	0.20	2.88	
	1000	35x80	0.15	4.26		560	35x80	0.20	3.66	
		40x61	0.15	4.26			40x61	0.20	3.13	
		45x50	0.15	4.29			45x60	0.20	3.33	
		50x50	0.15	4.77			50x50	0.20	3.54	
		35x80	0.15	4.56			35x80	0.20	3.25	
	1200	40x61	0.15	4.56		680	40x81	0.20	4.52	
		45x60	0.15	5.07			45x70	0.20	4.53	
		50x60	0.15	5.51			50x60	0.20	4.13	
		35x100	0.15	5.51			35x100	0.20	4.04	
	1500	40x81	0.15	5.52		820	40x81	0.20	3.95	
		45x80	0.15	6.14			45x80	0.20	4.20	
		50x80	0.15	6.66			50x70	0.20	4.57	
		40x101	0.15	6.67			40x101	0.20	4.82	
	1800	45x90	0.15	6.92		1000	45x90	0.20	4.88	
		50x90	0.15	7.51			50x80	0.20	5.13	
45x100		0.15	7.46	45x100	0.20		5.61			
2200	50x100	0.15	8.50	50x90	0.20	5.79				
				1200	50x100	0.20	6.64			
450(500)	560	35x60	0.15	2.94	550(600)	330	35x60	0.20	2.52	
	680	35x70	0.15	3.39		40x51	0.20	2.62		
		40x51	0.15	3.19		35x70	0.20	2.83		
		45x50	0.15	3.39		40x61	0.20	2.97		
	820	35x80	0.15	3.95		45x50	0.20	2.93		
		40x61	0.15	3.77		35x80	0.20	3.18		
		45x60	0.15	4.01		40x71	0.20	3.36		
		50x50	0.15	5.04		45x60	0.20	3.35		
	1000	35x90	0.15	4.39		50x60	0.20	3.19		
		40x81	0.15	4.50		35x90	0.20	3.52		
		45x70	0.15	4.51		40x81	0.20	3.75		
		50x60	0.15	5.03		45x70	0.20	3.76		
		35x100	0.15	4.80		50x60	0.20	3.61		
	1200	40x81	0.15	4.70		680	35x100	0.20	3.92	
		45x80	0.15	4.99			40x91	0.20	4.19	
		50x80	0.15	5.83			45x80	0.20	4.23	
		40x101	0.15	5.8			50x70	0.20	4.08	
	1500	45x90	0.15	5.88		820	40x101	0.20	4.27	
		50x90	0.15	6.7			45x90	0.20	4.33	
		45x100	0.15	6.75			50x80	0.20	4.55	
	1800	50x100	0.15	7.51		1000	45x100	0.20	4.14	
							50x90	0.20	5.07	
	500(550)	390	35x60	0.20		2.83	1200	50x100	0.20	5.65
		470	40x51	0.20		2.94				
35x60			0.20	2.59						
40x51			0.20	2.71						